

ecoBarn7.7

This attractive and infinitely adaptable system makes it a tasteful choice for a generous double car garage, a workshop, a new classroom or even the basis of a great house.

FEATURES

- Simple easy to assemble system - fully prefabricated, simply bolt together
- Fully engineered to meet the structural requirements of the Building Code of Australia
- Termite protected, Hyspan H2's laminated veneer lumber frame
- No measuring, no cutting, no cranes or other specialist equipment required
- Easy to follow drawings matching coded components
- Fully demountable - easily relocated, ideal for remote locations



Standard Dimensions

	span	bay widths	eave height	roof pitch
ecoBarn7.7	7.7m	3.6m	3.0m	15°

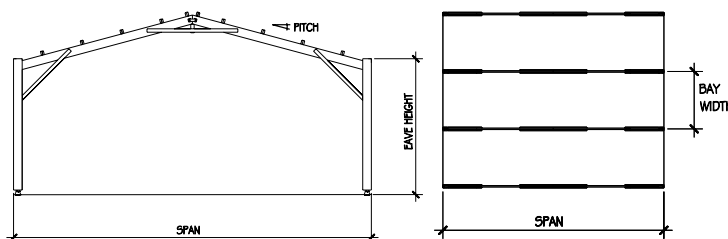

ADVANTAGES:

- Aesthetic appeal
- Well proportioned - bolted, rigid timber frame
- Looks and feels solid, quiet and warm
- Suited to many cladding options
- Durable for corrosive environments
- Need more space, simply add extra bays or lean to extensions

Note: optional **utilityClad©** textured plywood for a traditional timber appearance also available



BENEFITS FOR OUR ENVIRONMENT

ecoBarn designed and manufactured in Australia from Australian grown radiata pine - a totally renewable resource, retrieving carbon from the atmosphere and storing for the life of the structure.

Contribute positively to a reduction in greenhouse gas emissions, build with **ecoBarn** instead of other high carbon release materials



ecoBarn
Not just a shed



For enquiries contact Timberbuilt Pty Ltd

Telephone: (03) 9543 3733
Facsimilie: (03) 9543 3766
Email: ecobarn@timberbuilt.com.au
Web: www.timberbuilt.com.au/ecobarn.htm

Physical Address:
58A Whiteside Rd
Clayton
Victoria 3169

Postal Address:
PO Box 1181
Clayton South BC
Victoria 3169